

2,124 SQ. FT. - SANTA ANA
 Industrial / Warehouse / Distributing
3100 WEST WARNER AVENUE, SUITE 8

FOR LEASE

- Multi-Tenant Building
- High Traffic Area
- 53% Air Conditioned Office
- Good Shipping Location
- Includes Second Story
- Park-Like Environment

3100 W. Warner Avenue, Suite 8 Santa Ana	
Building Size-Sq.Ft.	2,124
Offices - Sq.Ft.	1,128
Warehouse - Sq.Ft.	996
Land Area - Sq.Ft.	P.O.L.B.
AMENITIES	
Clearance	13'-0" Min.
Coffee Bar/Lunch Area	Yes
Fenced Yard	No
Free Standing	P.O.L.B.
HV&AC	Offices
Overhead Doors - G.L.	1-10'x10'
Parking Spaces	3*
Power	100A/3PH
Restrooms - Offices	1
Restrooms - Warehouse	0
Skylights - Warehouse	Yes
Space Heaters	No
Sprinklered	No
Trash Enclosure	No
Warehouse Lighting	Fluorescent
Will Amortize Add'l T.I.'s	Yes
AVAILABLE	NOW
LOK BOX	CALL TO SHOW

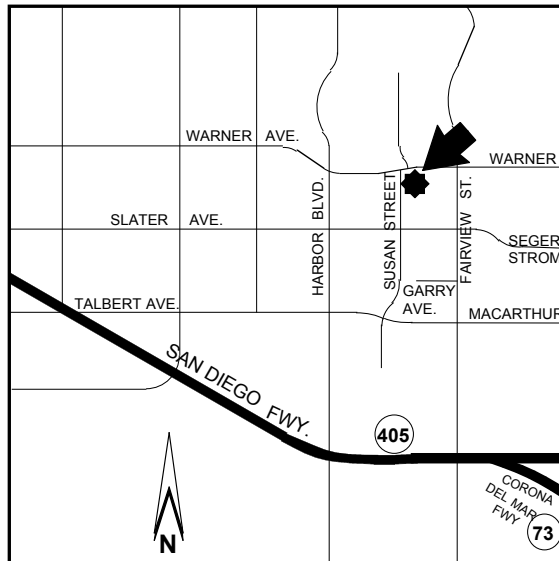

AREA MAP

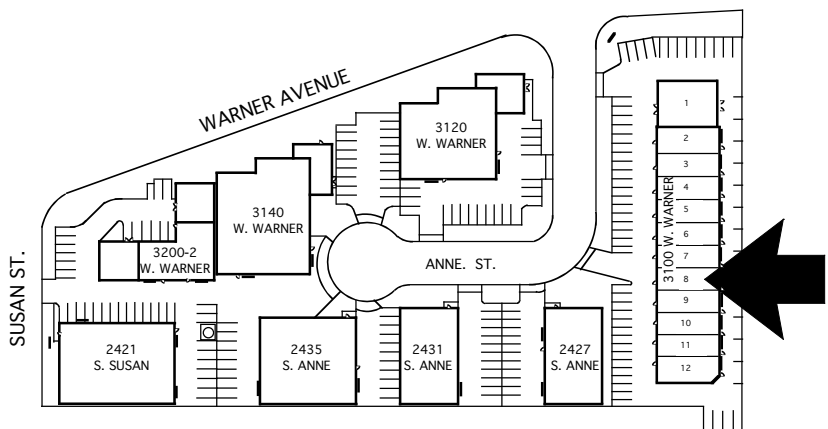

SITE PLAN

Floor Plan On Reverse

*Street Parking Also Available

All Dimensions Are Approximate; Drawings Not To Scale

ISIDORE C.
MYERS
 JOSEPH A.
ERICKSON
 Properties, Inc. www.icmyers.com

3100 WEST WARNER AVENUE, SUITE 8

FLOOR PLAN

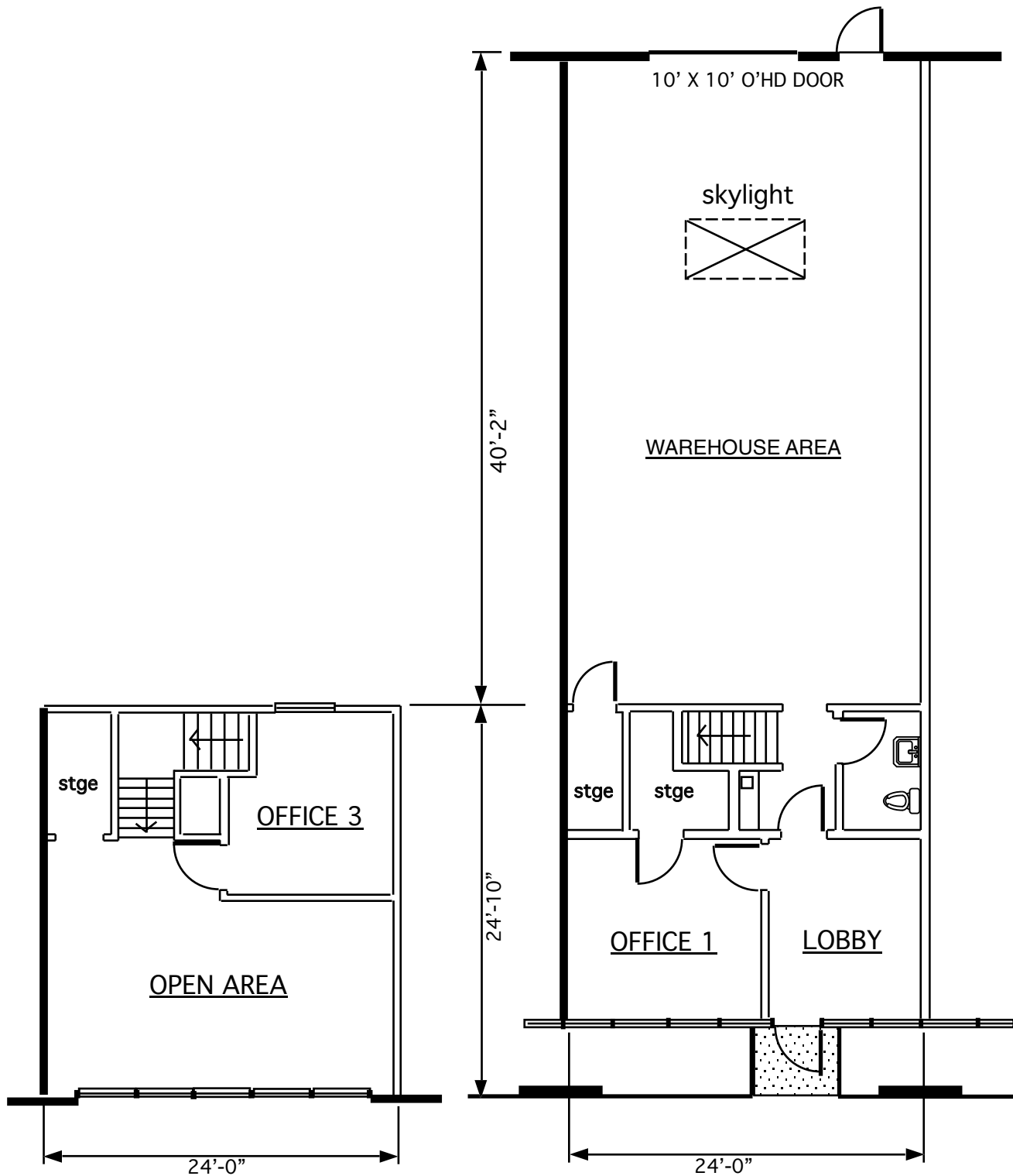

All Dimensions Are Approximate; Drawings Not To Scale

ISIDORE C.
MYERS
JOSEPH A. **ERICKSON**
Properties, Inc. www.icmyers.com